



Tribute Communities Centre

RETURN TO PLAY 2020 – Tribute Communities Centre Additional Protocols

COVID-19 ALERT:

We have taken enhanced health and safety measures to protect our venue guests. However, there is an inherent risk of exposure to COVID-19 in any public place where people are present. COVID-19 is an extremely contagious disease that can lead to severe illness and death. According to the PHA, senior citizens and guests with underlying medical conditions are especially vulnerable. By entering the venue, you voluntarily assume all risks related to exposure to COVID-19, and Venue disclaims any and all liability related thereto.

In accordance with the guidance and recommendations set forth by the PHA and local health officials, we respectfully request that the following guests not attend tonight's event:

- *Guests who are feeling sick or experiencing cold or flu-like symptoms (including fever, cough and shortness of breath);*
- *Guests who have been diagnosed with, or believe to have contracted, COVID-19, unless you have had no fever for 72 hours (without use of medicine) and 10 days have passed since symptoms first appeared;*
- *Guests who have been in contact with an individual diagnosed with COVID-19 within the past 14 days; and*
- *Guests who have traveled internationally in the past 14 days.*

For more information please visit <http://www.tributecommunitiescentre.com/news/detail/covid-19-guest-information>.

****All clients have a duty to notify the TCC immediately if a participant and/or guardian has tested positive for COVID-19 after visiting the TCC. ****

CLIENT EXPECTATIONS

- All clients must **20 minutes prior** to their rental start-time; **at their designated entrance**. All on-ice participants must arrive **fully dressed** (exception of helmet, gloves and skates). Players must also leave the facility fully dressed the way they came (same exceptions).
- Clients and instructors **MUST** use their designated entrance/exit – **no exceptions**. Please see below for maps and directions.
- Clients cannot enter the venue until instructed to do so by TCC management or venue security. Those who do not arrive **20 mins early** will be refused entry.
- All clients must check-in and provide full name and contact information at screening table as well as pass a **screening questionnaire**. All clients 16 years of age or younger must have a guardian check them in.





Tribute Communities Centre

- No *spectators* are permitted entry into the TCC at any time. **ONE guardian** is permitted per skater 16 years of age or younger. Applicable guardians will be welcome within a designated viewing area. Siblings or additional family members are not permitted. Please wait for instruction from TCC staff on your designated viewing area.
- Please note the TCC has a “no in and out” policy at this time. Upon arrival, please decide if you will be accompanying your player and/or staying for the remainder of the ice time.
- No more than 20 athletes and up to five instructors will be permitted on the ice - no exceptions.
- All clients must try to remain **two metres** apart at all times when inside the building.
- Anyone entering the TCC must wear a mask at all times (exceptions: while on the ice). Coaches/instructors who are not on ice, **MUST** wear a mask.
- Clients are asked to respect and follow directions of TCC staff and directional signage **at all times**.
- Upon entry, clients will be escorted to their respective “change zone”. Once ready, participants may not enter/exit the ice until instructed by TCC staff.
- Absolutely no spitting or horseplay at any time. These actions will not be tolerated.
- Use of any shower facilities will not be permitted.
- Please note; **outside food and beverage is not permitted into the venue**. A water bottle is permitted for on-ice participants only.
- If clients choose to park their vehicle in our parking lot, they must walk around the building to their designated entrance. Clients must also leave the venue immediately after their rental and skates are off. Please see map for details.
- Please note; all parking spots located on Red Tilson Lane are for Accessible permits **ONLY**. No drop offs permitted directly in front of Rink 2’s entrance on Red Tilson Lane.
- ****Please note it is very important to run on time****. All rentals will have a curfew based on their rental schedule.

RINK 1 DETAILS

- Designated entrance/exit for players on Rink 1 will be **Gate 1**.
- Two sections of the North Hall will be the designated athlete “change zone” and staging area, equipped with chairs two metres apart for each on-ice participant. TCC staff will direct you to this area of the North hall. Your applicable “zone” will be designated by TCC staff.
- All belongings can stay under the chairs of the respective change zones. Personal water bottles are permitted on the ledge of the benches.





Tribute Communities Centre

- The designated on-ice and off-ice exit will be relative to your “change zone”. Please see your TCC rep for more details.
- There will be **no access** to the rest of the venue including, Rink 1 event level washrooms, or Gate 3.
- Dressing Room 3 is a designated unisex washroom to be used by Rink 1 user groups and/or their Guardians only.
- There is absolutely no access to the stands and off-ice warm-ups are not permitted.

RINK 2 DETAILS

- Designated entrance will be the main **Rink 2 sliding door** entrance off Red Tilson Lane. Designated Exits will be based on your designated “change zone”. TCC staff will have more details upon arrival.
- Both “change zones” will have 20 chairs placed 2 meters apart for on-ice participants to lace/remove skates and 5 instructor chairs.
- The designated on-ice and off-ice exit will be relative to your “change zone”. TCC staff will provide more details when you arrive.
- All belongings can stay under the chairs of the client’s respective change zones. Personal water bottles are permitted on the ledge of the benches.
- No public access to the rest of the venue, including Rink 2 *hallway* washrooms or Ice Sales Office.
- Dressing Room 8 is a designated unisex washroom, to be used by on-ice patrons and/or Guardians only.
- There is absolutely no access to the stands and off-ice warm-ups are not permitted.

ON-ICE DETAILS – GROUP DETAILS

- *Any on-ice activity that permits non-intentional non-prolonged contact and meets our on-ice maximums can be approved.*
- If your group wishes to play shinny or scrimmage, the following rules apply:
 - All programs **MUST** be 3 on 3 with a total of 9 players and a goalie per team. This is the max number we can accommodate *while social distancing* on the bench.
 - Due to alternating Managers/Security working the check-in process every shift, music and your logo will not be permitted.
 - All *games* **MUST** be 1 hour in length (50 mins).
 - Battle drills, face-offs, or horseplay is not permitted.
- Please note all on-ice activities/type of rental must be approved by the TCC Ice Sales Department including bench use or that of similar nature. Please forward your requests to Steve.Brunet@spectrap.com.



Tribute Communities Centre

I have read and understand the rules and regulations associated with my rental contract at the Tribute Communities Centre. I certify that I understand the implications resulting in any of my clients or I not meeting or following the above protocols and/or the protocols outlined on the contract.

Contract # _____

Client Name

Client Signature

Date

TCC Acknowledgment

TCC Signature

Date



RINK 1 MAP

BUILDING FLOW MAPS PHASE TWO (A) – RINK 1

LEGEND

- No Access
- Stanchions / Bike Rack
- Direction of Travel
- Ice Entry / Exit Direction
- Convenor / Security Desk
- Chairs / Skate Change Area
- Zone 1 Guardian Viewing Area
- Zone 2 Guardian Viewing Area
- DRR Unisex Restroom

NOTES

Staff and referees to continue utilizing loading bay door.

Dressing Room 3 will be the designated restroom (DRR).

Guardian Viewing Areas will be in the lower bowl. Guardians are to sit in designated seats.

ROOMS	CODE	DESCRIPTION	OTHER	CODE	DESCRIPTION
AD		ADMINISTRATION OFFICE	MCS		MAIN CONCOURSE STAIRWELL
DR 1-5		DRESSING ROOMS	SW 1-4		STAIRWELLS 1-4
EO		EVENTS OFFICE	E 1-2		ELEVATORS 1 AND 2
FA		FIRST-AID ROOM	W		WASHROOMS
HL		HOUSE KEEPING SUPERVISOR OFFICE			
HL		HOUSE LIGHTS			
IS&P		ICE SALES & PROGRAMMING OFFICE			
LA		LAUNDRY			
LR		LEISURE ROOM (CATERING)			
MPA		MULTI-PURPOSE A (PRODUCTION)			
MPB		MULTI-PURPOSE B (PRODUCTION)			
RR		REFEREE ROOMS			
SP		SHOW POWER			
SR		STAFF ROOM			
VDR		VISITOR DRESSING ROOM (OVERSIZED DRESSING ROOM)			

SPACES	CODE	DESCRIPTION
F		FLOOR ACCESS
LB		LOADING BAY
RET		REMOVABLE RETRACTS
ZAM		ZAMBONI BAY

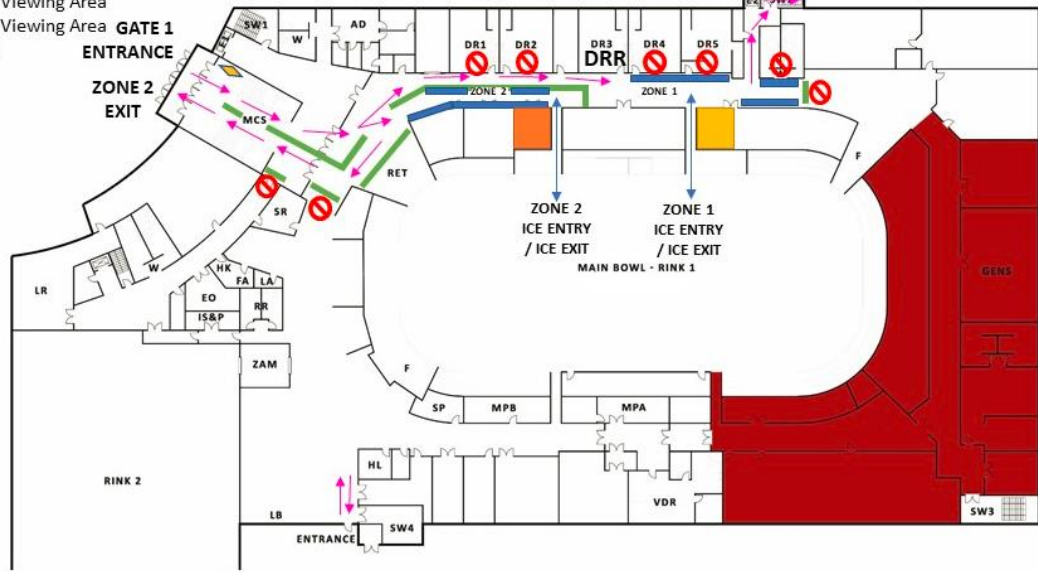

MASTER REOPENING PLAN | TRIBUTE COMMUNITIES CENTRE

RINK 2 MAP

BUILDING FLOW MAPS PHASE TWO (A) – RINK 2

LEGEND

- No Access
- Direction of Travel
- Entry / Exit Direction
- Convenor / Security Desk
- Chairs / Skate Change Area / Guardian Viewing Areas
- DRR Unisex Restroom

NOTES

Dressing Room 8 will be the designated restroom (DRR).

Alternating 'Skate Change' areas per hour for groups to reduce crossover traffic.

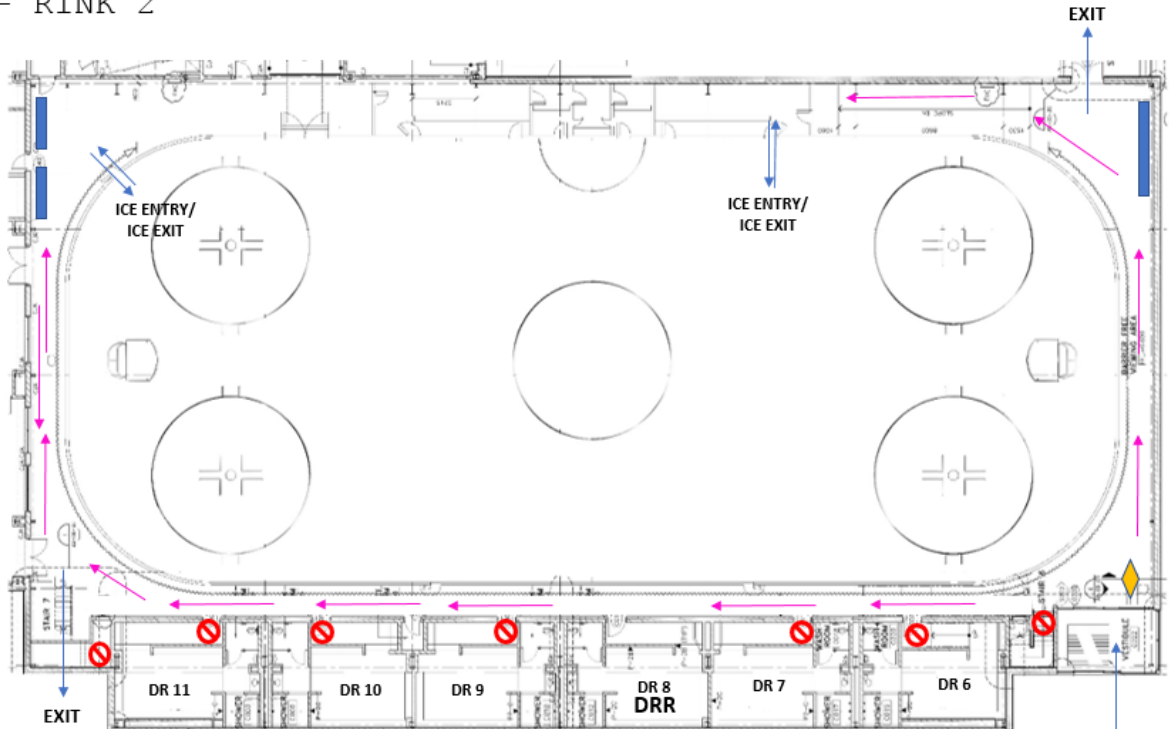

MASTER REOPENING PLAN | TRIBUTE COMMUNITIES CENTRE